

PROFILE
SCALE: HORIZ. 1"=20'
VERT. 1"=2'

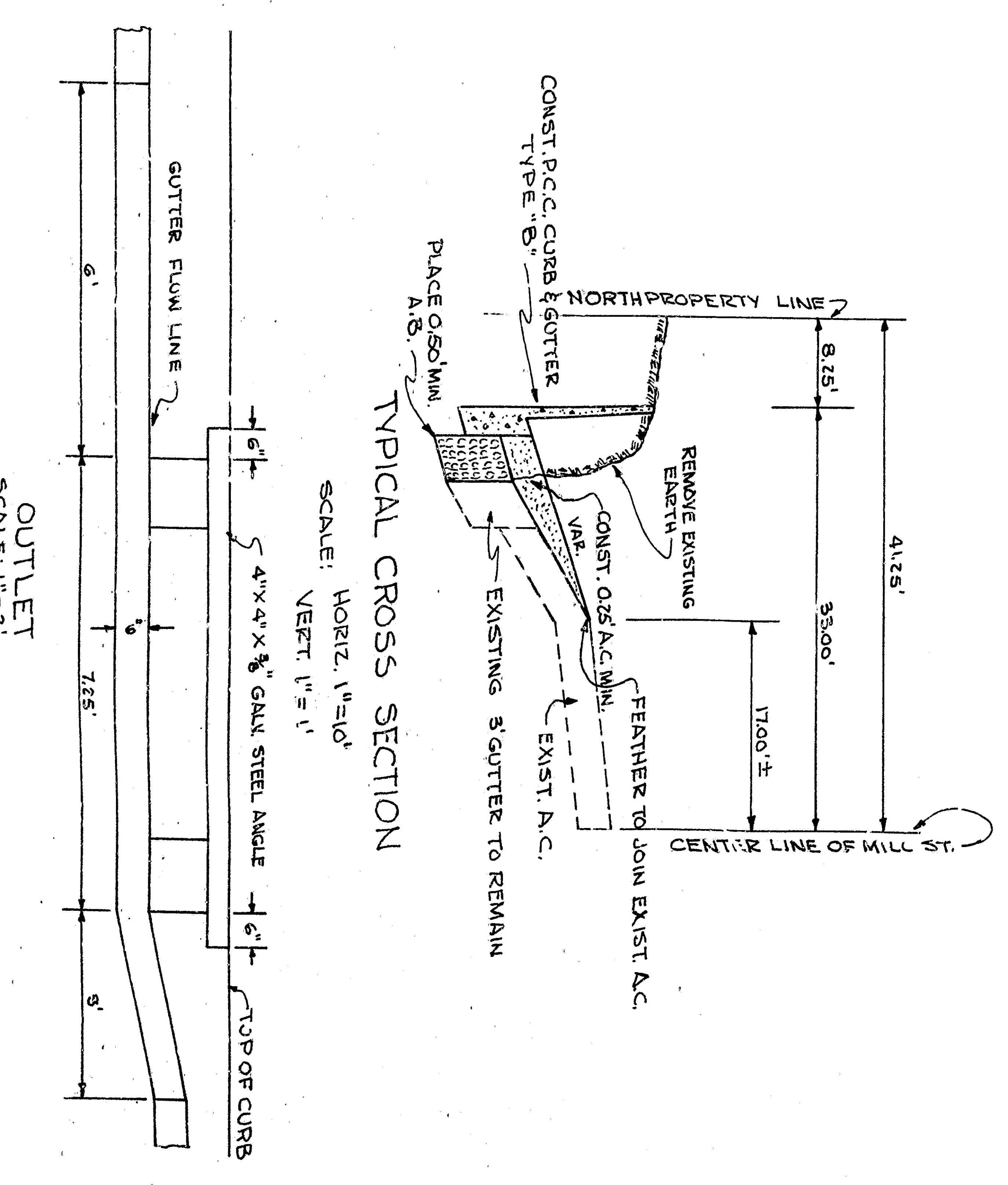
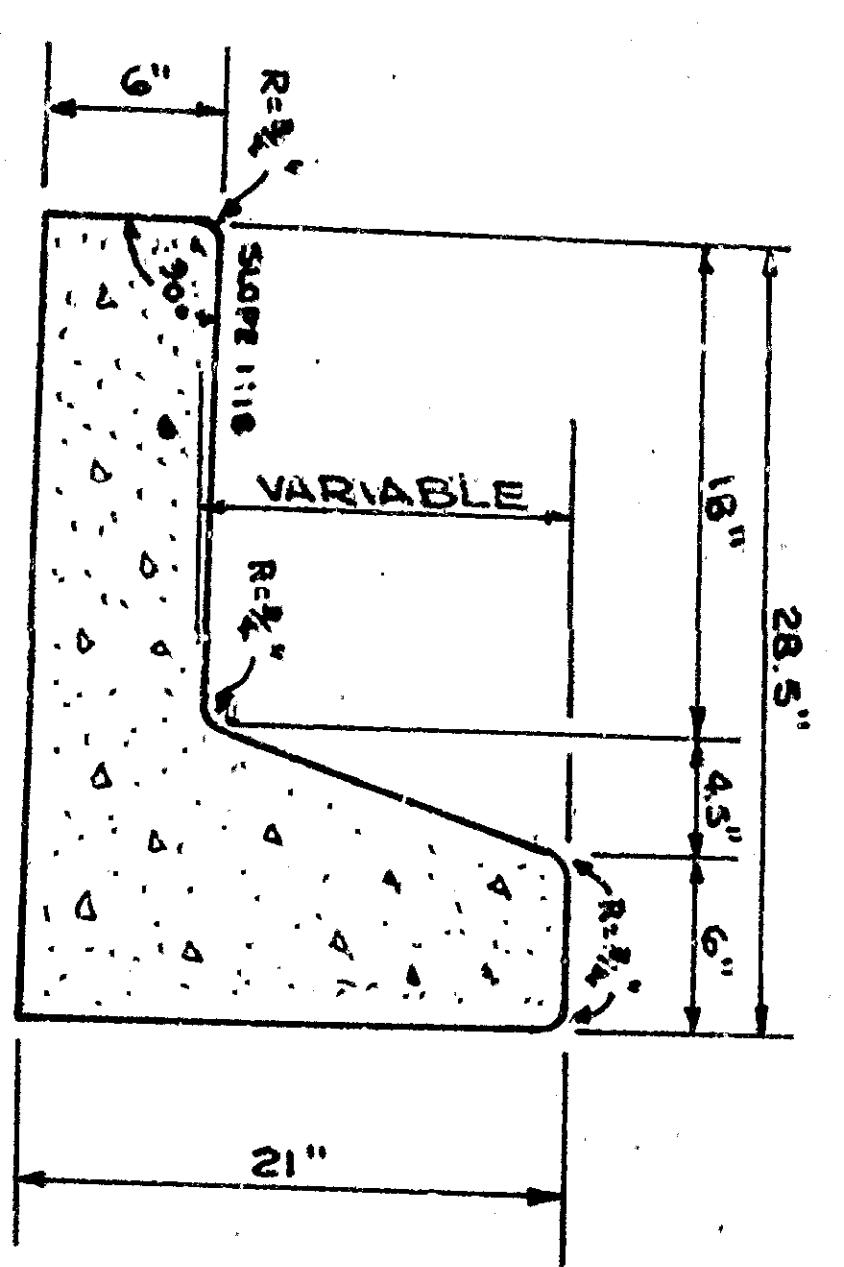
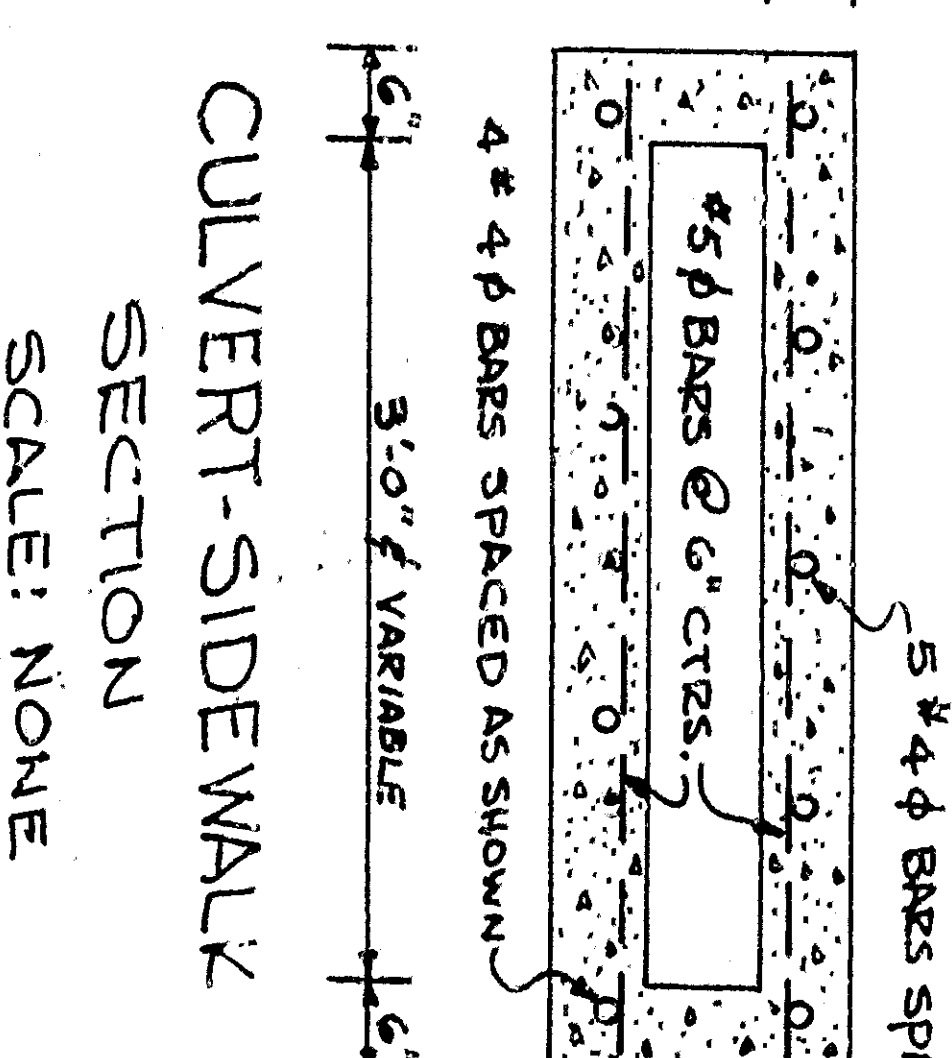
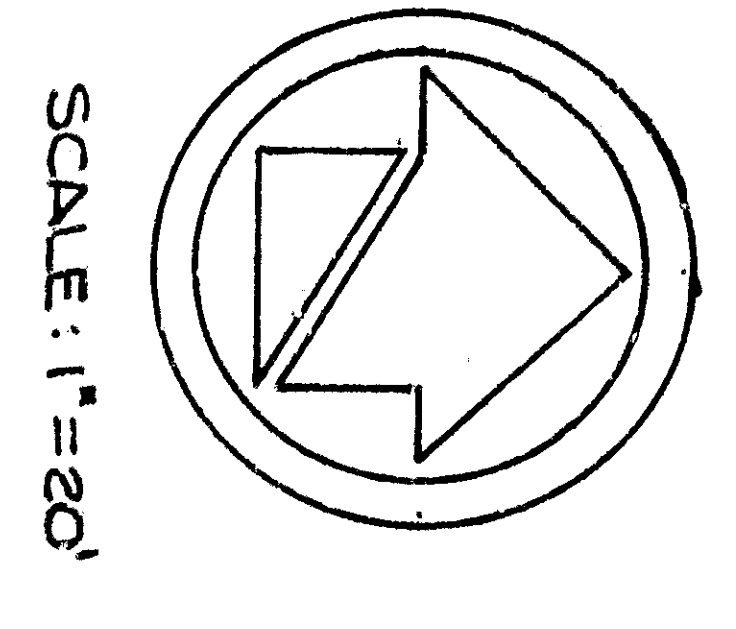

GENERAL NOTES:
1. ALL WORK EMPLOYED ON THIS PLAN SHALL BE IN ACCORDANCE WITH THE APPLICABLE PROVISIONS OF THE CITY AND SPECIFICATIONS NO. 2311 DATED NOVEMBER, 1964- AND STANDARD DRAWING NO. 2321 ON FILE IN THE OFFICE OF THE CITY ENGINEER.
2. BENCH MARK:
CENTER LINE OF MILL ST. AND ARROWHEAD AVE. - EL. 997.95 M.S.L.

APPROVED: [Signature] 1969
CITY ENGINEER
REGISTERED CIVIL ENGINEER IN ILLINOIS
DRAWING NO. 3352
DESIGNED BY [Signature]
CHECKED BY [Signature]
SHEET 1 OF 1
RECOMMENDED
1 SHEETS

DEPARTMENT OF ENGINEERING
CITY OF SAN BERNARDINO
IMPROVEMENT PLAN
NORTHWEST CORNER OF MILL ST AND
PERSHING AVE.


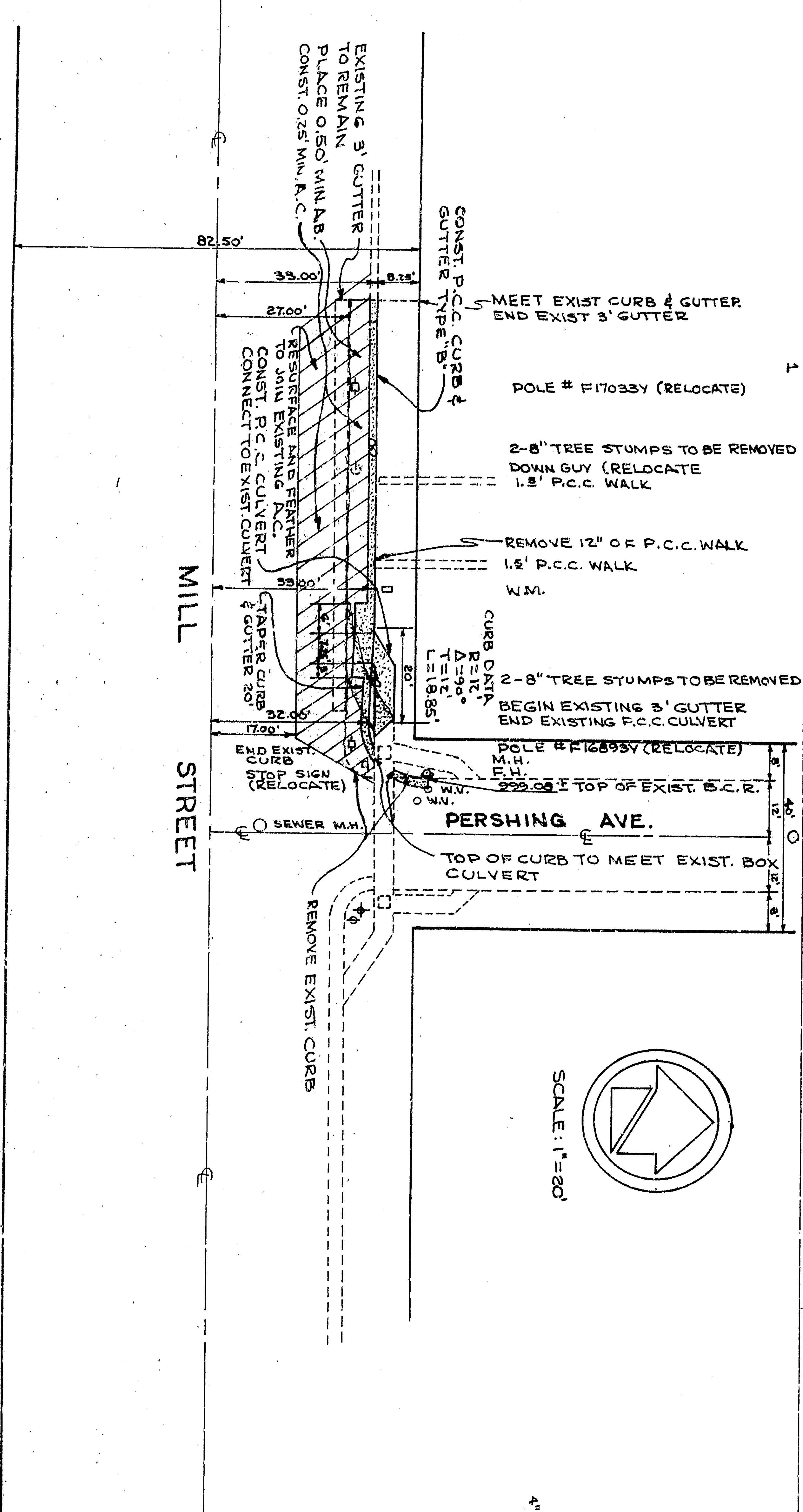

PROFILE
SCALE: HORIZ. 1"=20'
VERT. 1"=2'

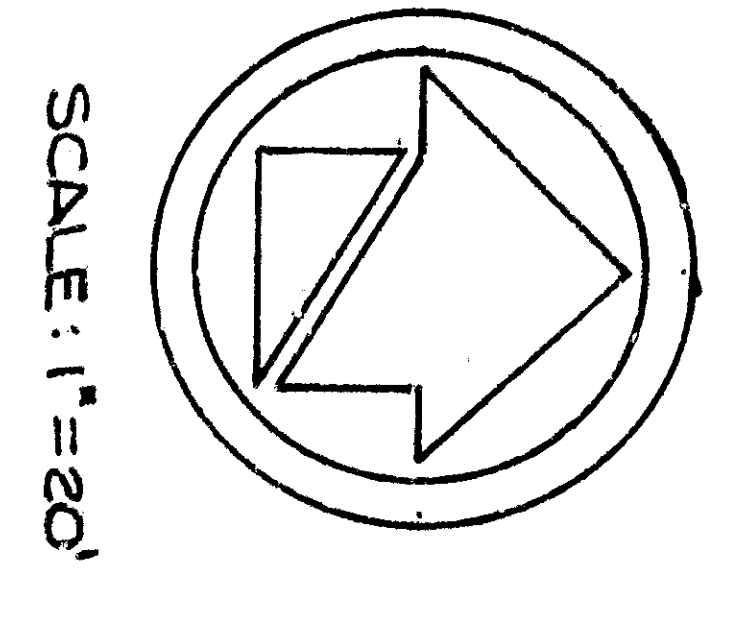

SCALE: 1"=20'

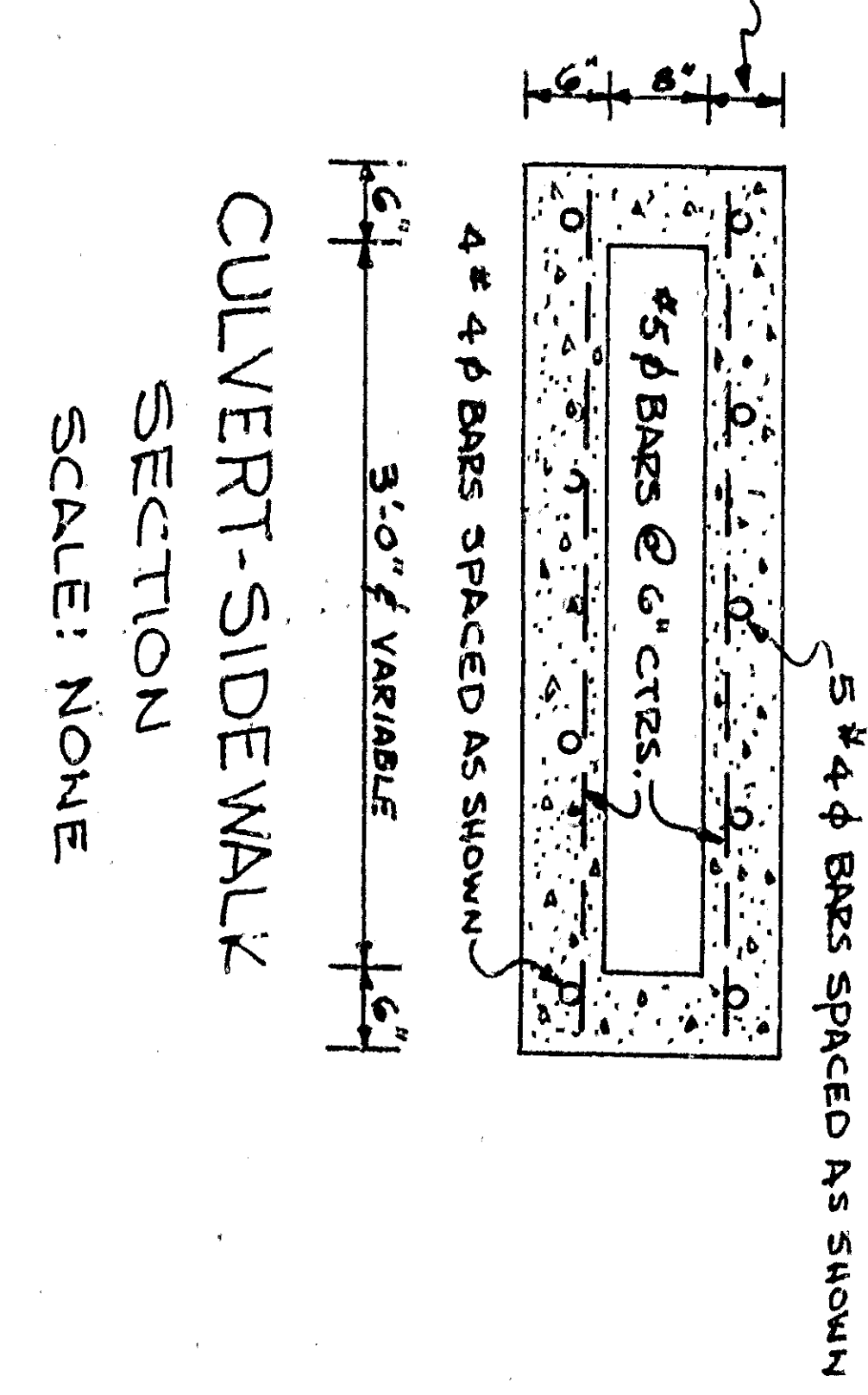

CULVERT-SIDEWALK SECTION
SCALE: NONE

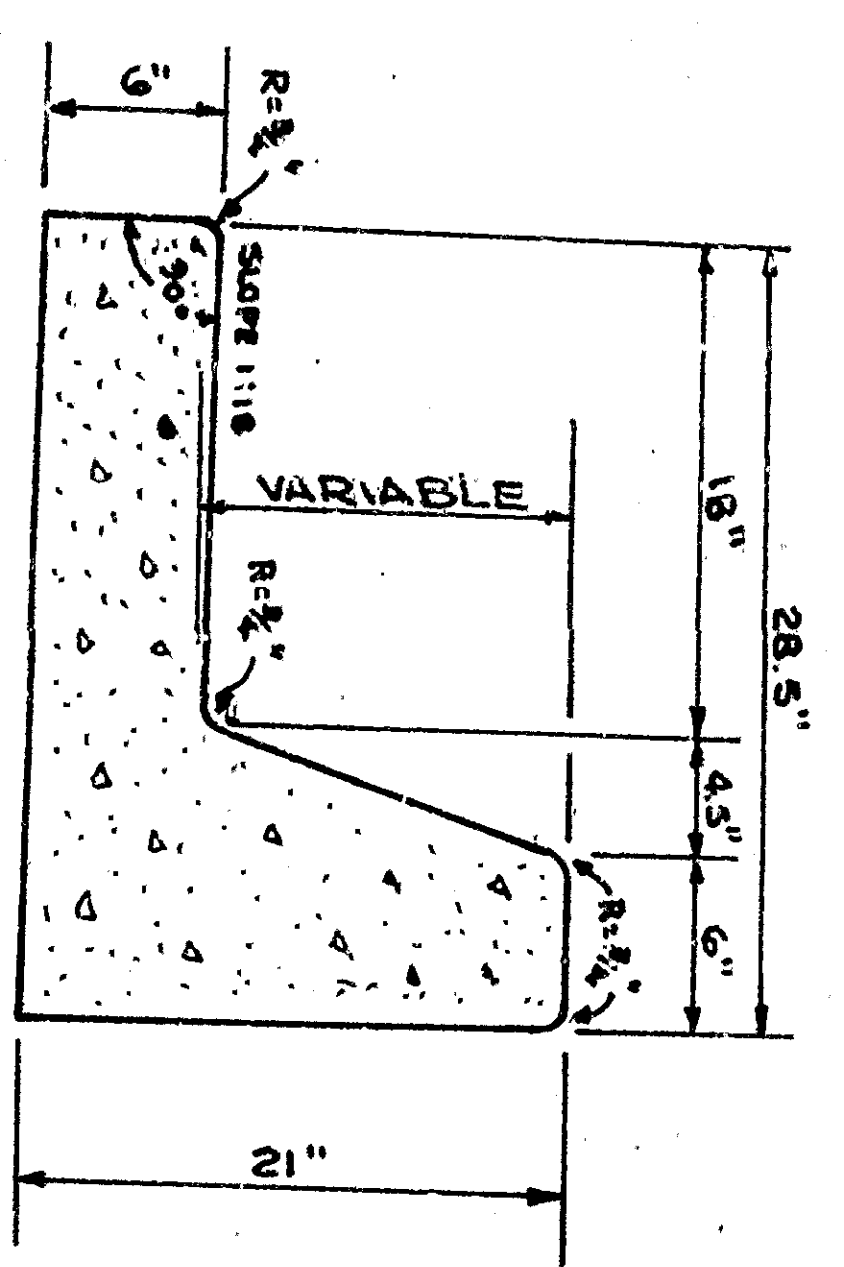

TYPICAL SECTION CURB & GUTTER
SCALE: 1"=1'

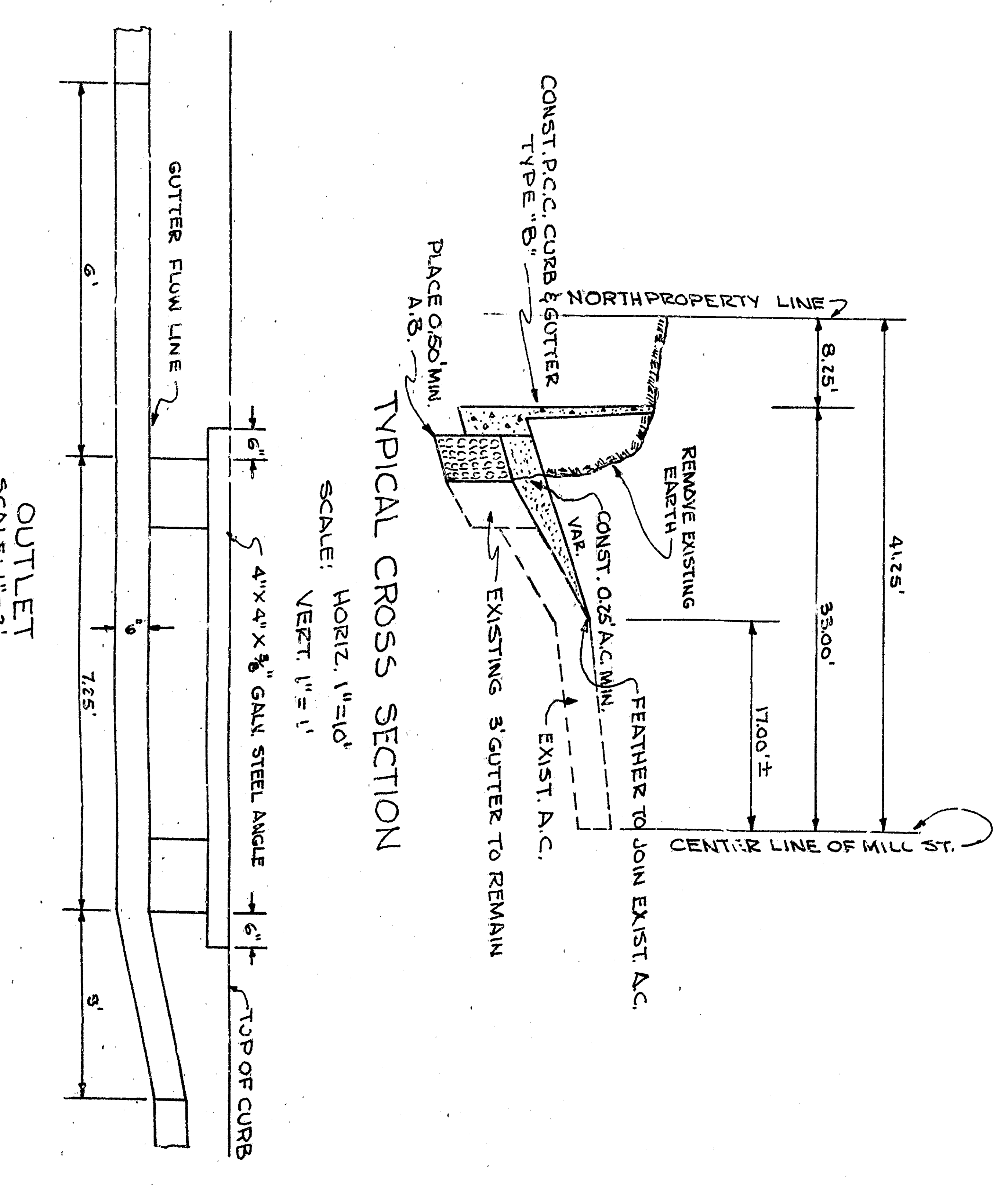

TYPICAL CROSS SECTION
SCALE: HORIZ. 1"=10'
VERT. 1"=1'

- GENERAL NOTES:**
1. ALL WORK EMPLOYED ON THIS PLAN SHALL BE IN ACCORDANCE WITH THE APPLICABLE PROVISIONS OF THE STANDARD SPECIFICATIONS FOR HIGHWAY CONSTRUCTION, 1964 EDITION, AND NOVEMBER, 1964-AND STANDARD DRAWING NO. 2521, ON FILE IN THE OFFICE OF THE CITY ENGINEER.
 2. BENCH MARK: CENTER LINE OF MILL ST. AND ARROWHEAD AVE. - EL. 997.95 M.S.L.

APPROVED: <i>[Signature]</i> 1969	DEPARTMENT OF ENGINEERING
BY: <i>[Signature]</i>	CITY OF SAN BERNARDINO
REGISTERED CIVIL ENGINEER NO. 13663	IMPROVEMENT PLAN
DRAWING NO. 3352	NORTHWEST CORNER OF MILL ST AND PERSHING AVE.
DESIGNED BY: <i>[Signature]</i>	
CHECKED BY: <i>[Signature]</i>	
1 SHEETS	